

賃貸物件概要書 / LEASE PROPERTY INFORMATION

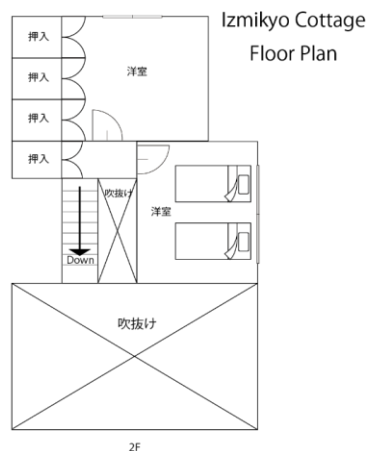
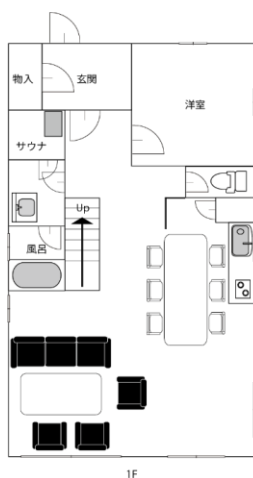

Izumikyo Cottage
Floor Plan

物件情報 / PROPERTY SUMMARY

物件名 / Property Name	泉郷コテージ / Izumikyo Cottage		
物件住所 / Address	倶知安町字山田83番98 / 83-98 Aza-yamada, Kutchan-cho		
部屋番号 / Unit	Whole House		
間取りタイプ / Rooms	2LDK + Loft / For 6 people		
専有面積 / Floor Area	91.66 m ²		
契約種別 / Type of Agreement	定期住宅賃貸借 / Fixed Term leasing (Min 5 months for winter)		
駐車場 / Parking	1		
新築年月日 / Newly Build	1992/10/12		

費用・経費 / COST & FEES

月額家賃 / Monthly Rent	Only Summer May~Oct	¥160,000	Only Winter Nov~Apr	¥320,000	Year Round	¥240,000
管理費 / Management Fee	¥5,000 / Month					
敷金 / Security Deposit	¥80,000		¥360,000		¥200,000	
鍵交換費用 / Key replacement costs						-

その他
OTHERS

退去時清掃費 Departure Cleaning fee	¥64,800	(Included tax)
礼金 Key money	Exist	(1month of rent + tax)
冬季除雪費 Snow Clearing Fee	(To be informed around August)	
Fully furnished		
シーツ等のリネンは自費となります。		



190-15 Aza-Yamada, Kutchan-cho, Abuta-gun

0136-21-5060

www.nisekoproperty.com

sales@nisekoproperty.com